

Latimea danturii "h" per modul: 50 mm

Latimea totala "H" per modul: 75 mm

Unghi de angrenare: 20°

Material: otel C45E-UNI EN 10083-1

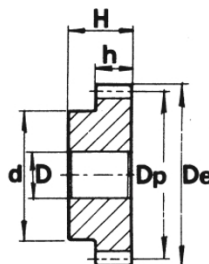
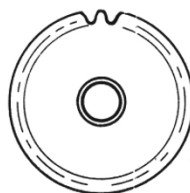

Z (numar de dinti)	Cod	De (mm)	Dp (mm)	d (mm)	D (mm)
12	PM 32012	70	60	45	16
13	PM 32013	75	65	50	16
14	PM 32014	80	70	55	20
15	PM 32015	85	75	60	20
16	PM 32016	90	80	65	20
17	PM 32017	95	85	70	20
18	PM 32018	100	90	70	20
19	PM 32019	105	95	70	20
20	PM 32020	110	100	80	20
21	PM 32021	115	105	80	20
22	PM 32022	120	110	80	25
23	PM 32023	125	115	90	25
24	PM 32024	130	120	90	25
25	PM 32025	135	125	90	25
26	PM 32026	140	130	100	25
27	PM 32027	145	135	100	25
28	PM 32028	150	140	100	25
29	PM 32029	155	145	100	25
30	PM 32030	160	150	100	25
32	PM 32032	170	160	110	25
36	PM 32036	190	180	110	25
38	PM 32038	200	190	110	30
40	PM 32040	210	200	110	30
42	PM 32042	220	210	120	25
55	PM 32055	285	275	120	30
60	PM 32060	310	300	120	30
80	PM 32080	410	400		30
100	PM 32100	510	500		30